



.49 Headstone Gardens Harrow, HA2 6PH

£639,950

This well-presented three-bedroom semi-detached home offers generous living space and a practical layout, ideal for families or commuters. The bright and spacious living room features a charming centrepiece fireplace, while the well-fitted kitchen includes a range of wall-mounted and base units. A sizable dining room—currently used as a bedroom—adds further flexibility to the ground floor.

Upstairs, the property offers two good-sized double bedrooms and a further single bedroom. The large family bathroom and separate WC provide convenience for busy households.

Outside, the fully enclosed rear garden includes a patio area perfect for outdoor dining or relaxation. To the front, a large driveway provides ample off-street parking. The home also benefits from full double glazing and gas central heating.

A major advantage of this property is the granted planning permission valid until 25th May 2026, allowing for extensive future development. Approved works include:

- A single-storey front extension incorporating a porch
- Single and two-storey side-to-rear extensions
 - A single-storey rear extension
 - Roof alterations and a rear dormer
- External alterations, including demolition of the attached garage

These plans offer an excellent opportunity to significantly expand and tailor the home to suit your needs.

.49 Headstone Gardens, Harrow, HA2 6PH

Entrance

Living room

Dinning room

Kitchen

Downstairs WC

Garden

Master bedroom

Bedroom Two

Bedroom Three

Bathroom

separate WC



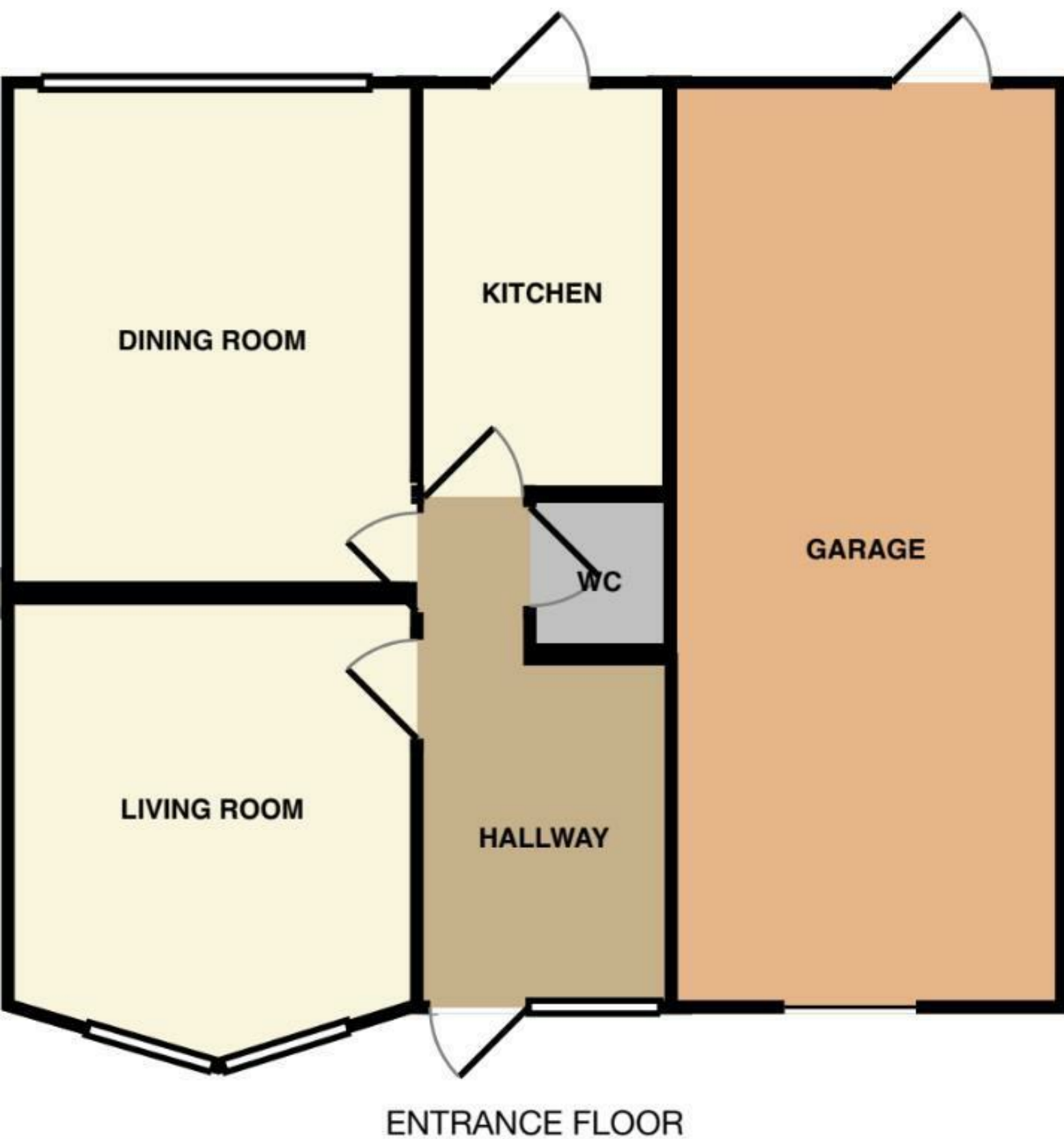

Energy Efficiency Rating		Environmental Impact (CO ₂) Rating	
	Current	Potential	
Very energy efficient - lower running costs			
(92 plus) A			
(81-91) B			
(69-80) C			
(55-68) D			
(39-54) E			
(21-38) F			
(1-20) G			
Not energy efficient - higher running costs			
England & Wales		EU Directive 2002/91/EC	
		79	
		54	

Environmental Impact (CO ₂) Rating		Current	
	Potential		
Very environmentally friendly - lower CO ₂ emissions			
(92 plus) A			
(81-91) B			
(69-80) C			
(55-68) D			
(39-54) E			
(21-38) F			
(1-20) G			
Not environmentally friendly - higher CO ₂ emissions			
England & Wales		EU Directive 2002/91/EC	